

- Order Limits
  - Canal
  - New road infrastructure and improvements to existing infrastructure.
  - Landscaping
  - Mounding
  - Dry Attenuation (precise location and extent to be approved at time of submission of details for approval post DCO approval)
  - Wet Attenuation Ponds (precise location and extent to be approved at time of submission of details for approval post DCO approval)
  - Community Park Boundary
  - Acoustic Fencing
  - Existing Conserved Woodland / Trees to be retained
  - Existing Conserved Hedgerows to be retained
  - Existing Veteran Trees to be retained
  - Plot Access Points through Green Infrastructure. (precise location and extent to be approved at time of submission of details for approval post DCO approval)
  - +3m to +8m Height of mounding (relative to the adjoining development zone's finished floor level (FFL) as shown on document 2.6)
- Note:**  
Height of mounding to the eastern side of the canal is relative to the new road infrastructure

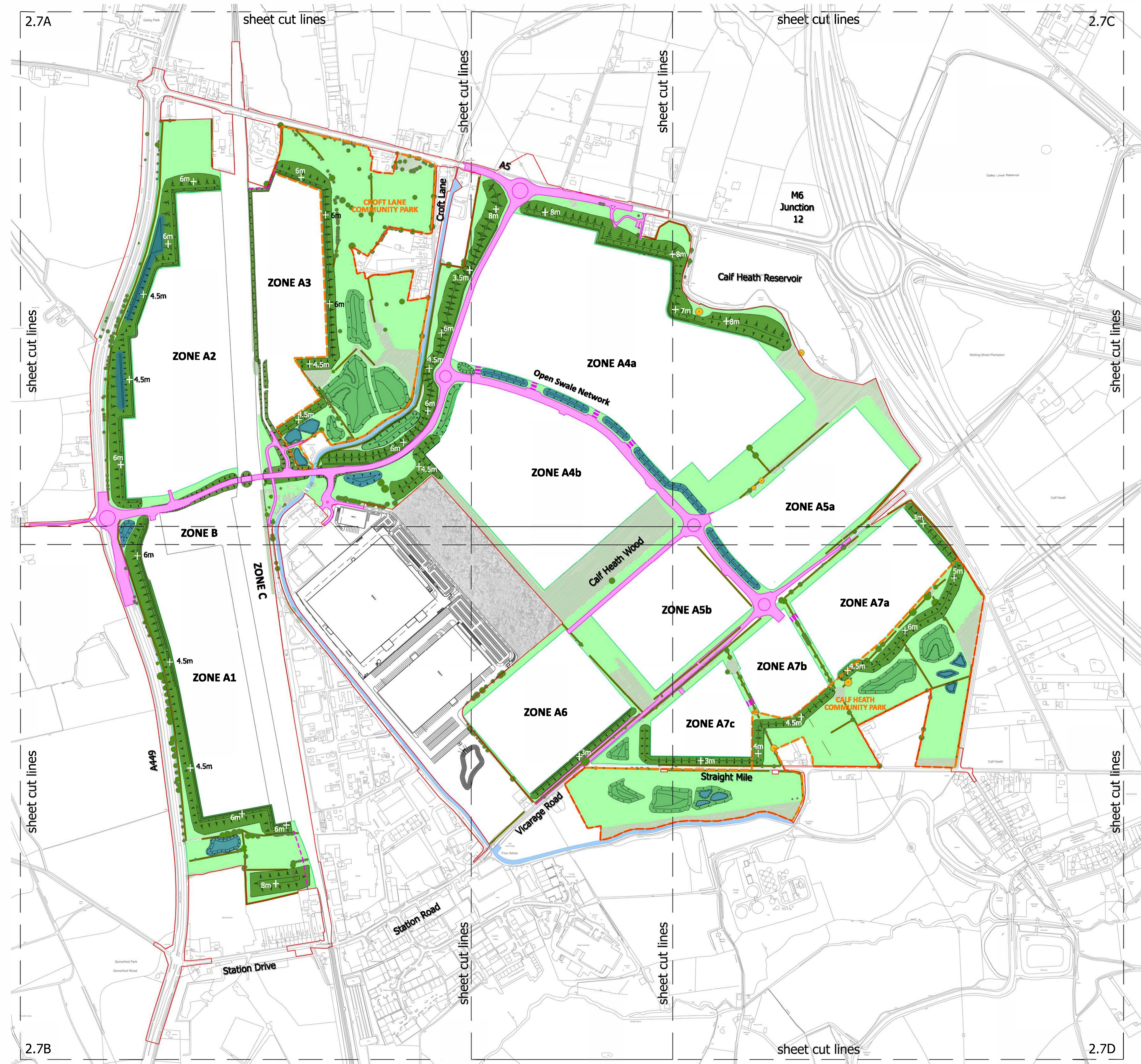

Project <b>THE WEST MIDLANDS RAIL FREIGHT INTERCHANGE ORDER 201X</b>	
Drawing Status <b>SUBMISSION</b>	
Drawing Title <b>KEY PLAN - PARAMETERS PLAN GREEN INFRASTRUCTURE PLAN</b>	
Regulation <b>5 (2) (a)</b>	Document <b>6.2 - Figure 4.3</b>
Drawing No. <b>4049 - 1033</b>	Rev. <b>05</b>